

Commune de ST GEORGES DE REINTEMBAULT

Lieu dit " La Leteurrie "

Lotissement Communal







Arrêté Municipal du 01 juillet 2013

PLAN DE BORNAGE

Cadastre Section AD

Echelle 1/500è

LEGENDE:

-  Borne OGE nouvelle
Altitude borne rattaché au plan
fourni par TECAM
-  Piquet
-  Limite réelle
-  Limite cadastrale indicative
-  Talus masse
-  Cote partielle
-  Cote totale

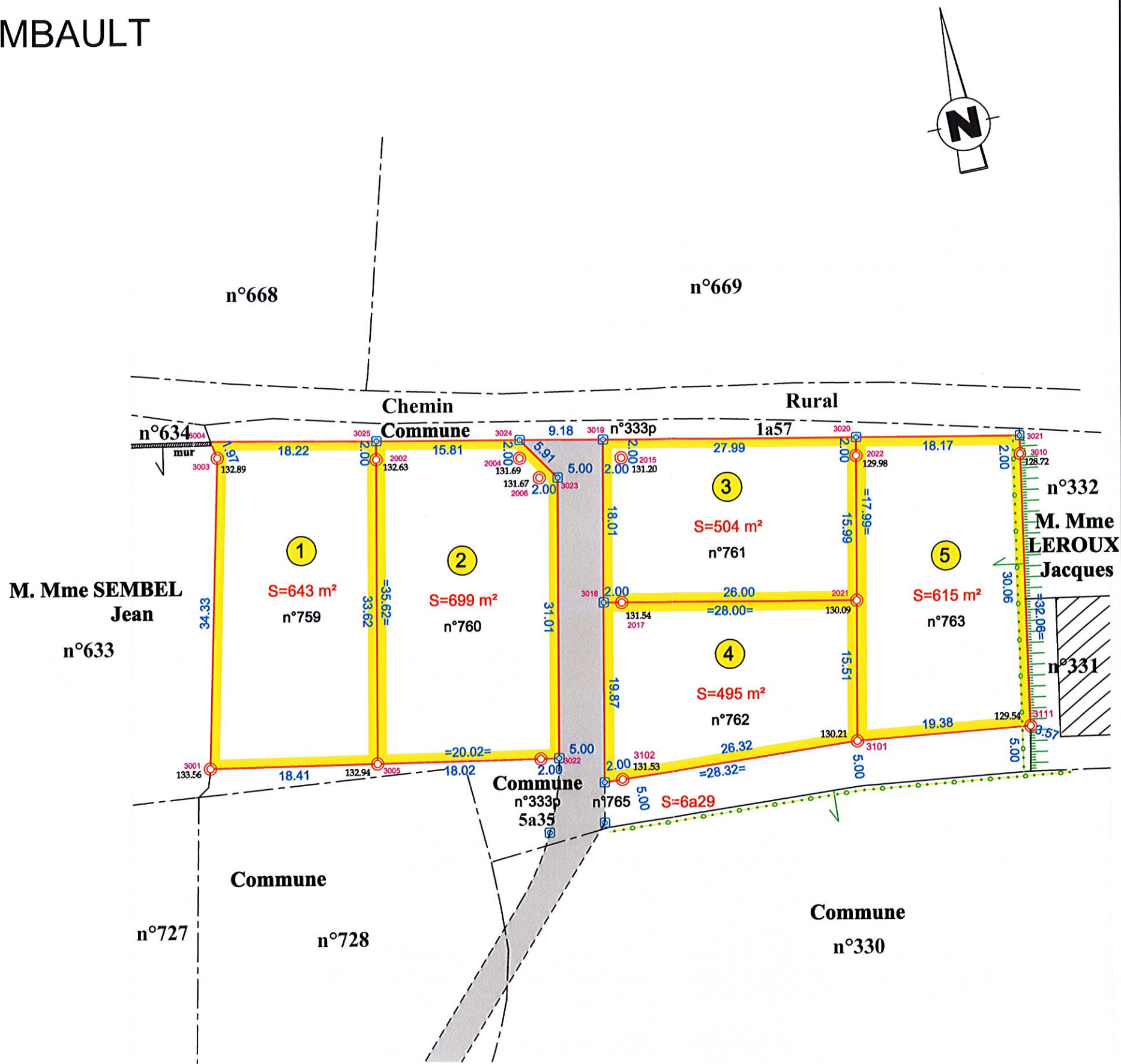

Société d'Etudes et de Gestions Urbaines et Rurales

S.a.r.l. SEGUR Géomètres-Experts

S.a.r.l. SEGUR - M. Charles GERARD - 95, rue Waldeck Rousseau - 50600 SAINT HILAIRE DU HARCOUET

Tél : 02.33.49.13.17 Fax: 02.33.49.62.82 Email: segur.sthilaire@orange.fr

Dossier : H1066

Date : 09 avril et 04 septembre 2013